

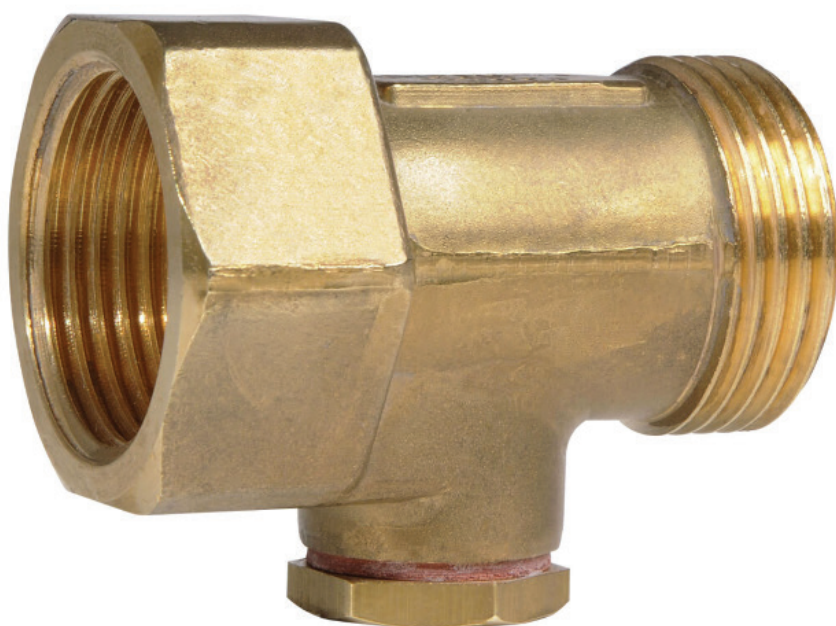

Check valve

## Technical datasheet



## Description

The non-return valve W is certified to the NF antipollution norms. This non-return valve is designed for the protection of drinking water against polluted backflow which has no recognized toxic or microbiological risks to human health.

- Minimum head loss, silent and robust
- Closing system: double axial guiding with return spring
- Does not generate hammering
- Excellent sealing at high as well as low pressure ensured by a specially designed lip ring seal

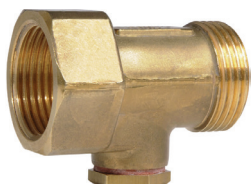

# W

Check valve

DN		PFA/PS in bar	Ref.	Weight Kg
"	mm			
1/2	15	10	<b>2231153</b>	0,13
3/4	20	10	<b>2231253</b>	0,18

### Technical features

Operating temperature	Mini.: -10 °C / Continuous: 65 °C / Short-term (1h/day) : 90 °C
Permissible operating temperature (PFA) in water	See table above
Maximum permissible (PS) other mediums	See table above
Connection	Female/Male
Mediums	Clear liquids

### Nomenclature and materials

N°	Designation	Materials
1	Body	Brass
2	Cartridge	
3	Guide	Hostaform
4	Seal	EPDM
5	Spring	Stainless steel
6	Plug + seal	Brass + EPDM

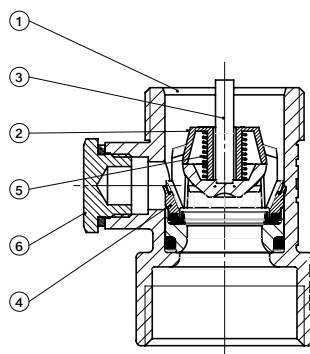

## Approvals



International Construction Standards :  
EN 1717

## Application

Housing, water distribution, protection of drinking water networks.

## Operation

### Direction for use :

- Solid line : Valve completely open
- Dotted line : Opening stage of valve

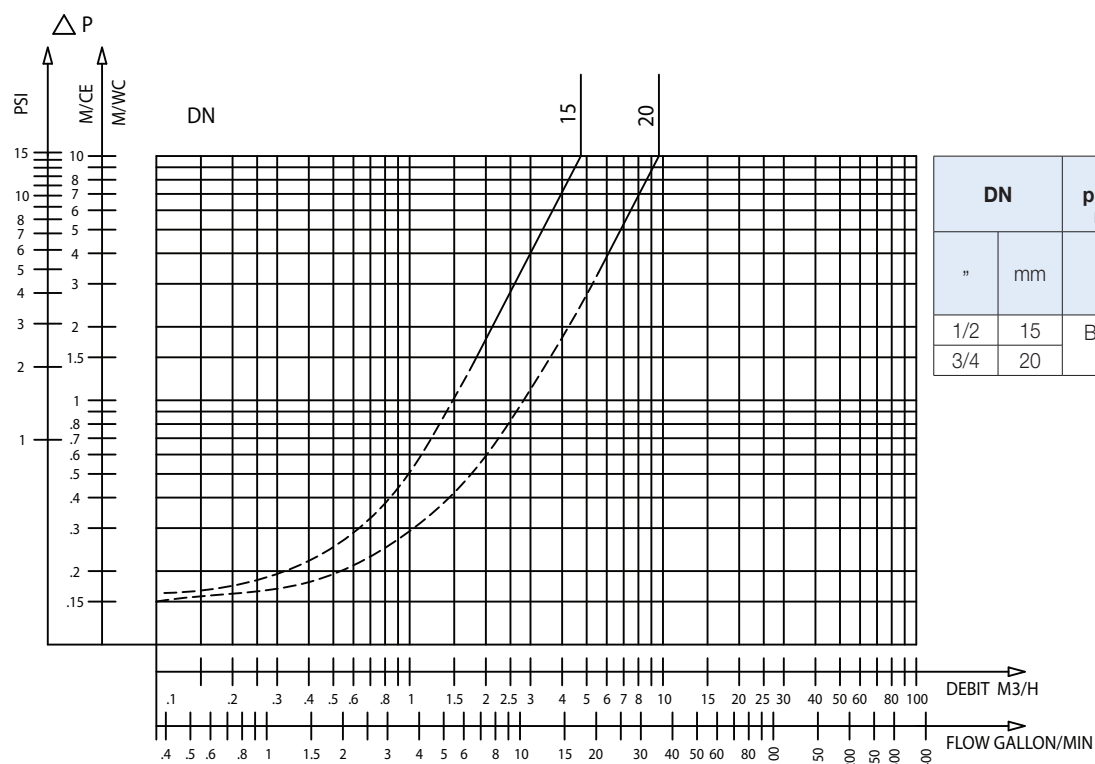

DN		Opening pressure in mm / CE	Kv	$\zeta$
"	mm		m³/H	
1/2	15	Between 50 and 200	4,75	3,6
3/4	20		9,65	2,75

W - Headloss chart

# Sizing

DN	Connection A	B	C
mm	"	mm	mm
15	3/4	32	50
20	1	37	54

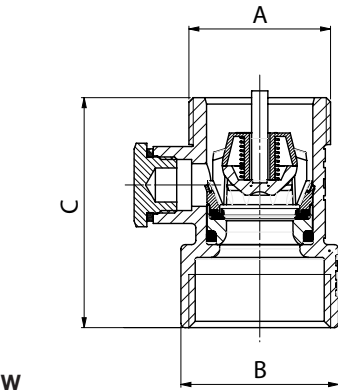

The descriptions and photographs contained in this product specification sheet are supplied by way of information only and are not binding.

Watts reserves the right to carry out any technical and design improvements to its products without prior notice. Warranty : All sales and contracts for sale are expressly conditioned on the buyer's assent to Watts terms and conditions found on its website at [www.watts.com](http://www.watts.com). Watts hereby objects to any term, different from or additional to Socla terms, contained in any buyer communication in any form, unless agreed to in a writing signed by an officer of Watts.



**WATTS INDUSTRIES France**  
1590 avenue d'Orange • CS 10101 Sorgues 84275 VEDENE CEDEX • France  
Tél. +33 (0)4 90 33 28 28 • Fax +33 (0)4 90 33 28 39  
[contact@wattswater.com](mailto:contact@wattswater.com) • [www.watts.eu](http://www.watts.eu)